

## GENERAL PRODUCT INFORMATION

### BASIC DATA

Product code	3018
Shape	Square
Lid type	Venting
Weight	4.5 g.

### DIMENSIONS

Size	95 x 95 mm.
D1	92.7 mm.
D2	89.3 mm.
H1	2.6 mm.
H2	7.3 mm.

### MATERIAL

Raw material	Polypropylene
Temperature	Temperature on request
Colour	Colour on request

### CLOSURE

<b>Closure system</b>	Tamper evident closure
	Snap-on
	Protective collar

### IML DECORATION

IML	Enquire
Offset print	Enquire

Note: Please enquire about specific print-layouts

### TUB OPTIONS

4012
4014
4016
4018

Note: Please find the datasheets on our website: [www.toppac.dk](http://www.toppac.dk)

### TOLERANCES

Weight	± 10% ± 0.45 g.
Dimensions	± 1%

## LID SQUARE 3018

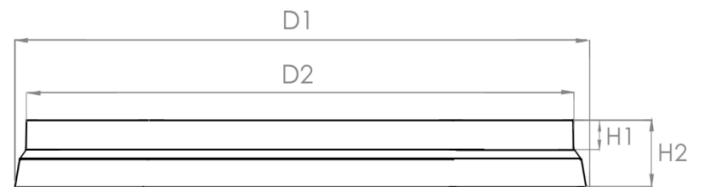

### STANDARD PACKAGING

Lids/box	Units/pallet	Qty./pallet
2.760	12	33.120

### PACKAGING SIZE

Unit	Size
Box	590 x 400 x 360 mm.
Pallet	1200 x 800 x 1230 mm.