

GENERAL PRODUCT INFORMATION

BASIC DATA

Product code	3020
Shape	Rectangular
Lid type	Standard
Weight	7.0 g.

DIMENSIONS

Size	95 x 129 mm.
D1	92.5 mm.
D2	89.0 mm.
D3	125.5 mm.
H1	2.6 mm.
H2	7.2 mm.

MATERIAL

Raw material	Polypropylene
Temperature	Temperature on request
Colour	Colour on request

CLOSURE

Closure system	Tamper evident closure
	Snap-on
	Protective collar

IML DECORATION

IML	Yes
Offset print	Yes
D4	81.5 mm.
D5	115 mm.

Note: Please enquire about specific print-layouts

TUB OPTIONS

4024
4027

Note: Please find the datasheets on our website: www.toppac.dk

TOLERANCES

Weight	± 10% ± 0.7 g.
Dimensions	± 1%

LID RECTANGULAR 3020

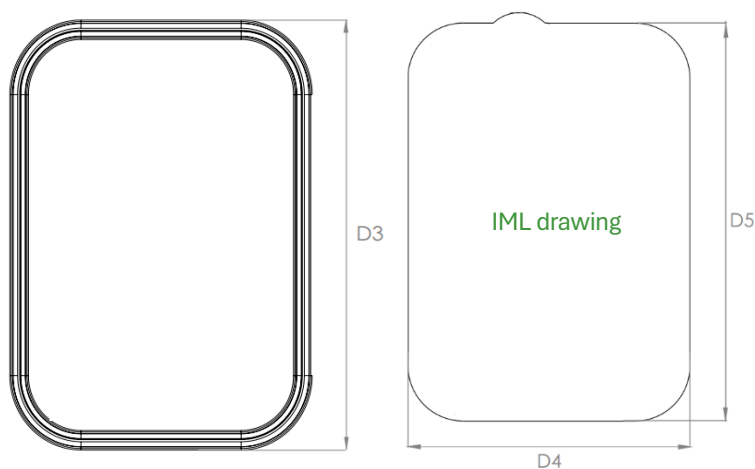
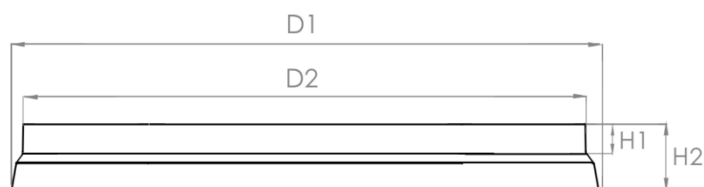

STANDARD PACKAGING

Lids/box	Units/pallet	Qty./pallet
2.070	12	24.840

PACKAGING SIZE

Unit	Size
Box	590 x 400 x 360 mm.
Pallet	1200 x 800 x 1230 mm.